

StreetJet

Assembly Instructions

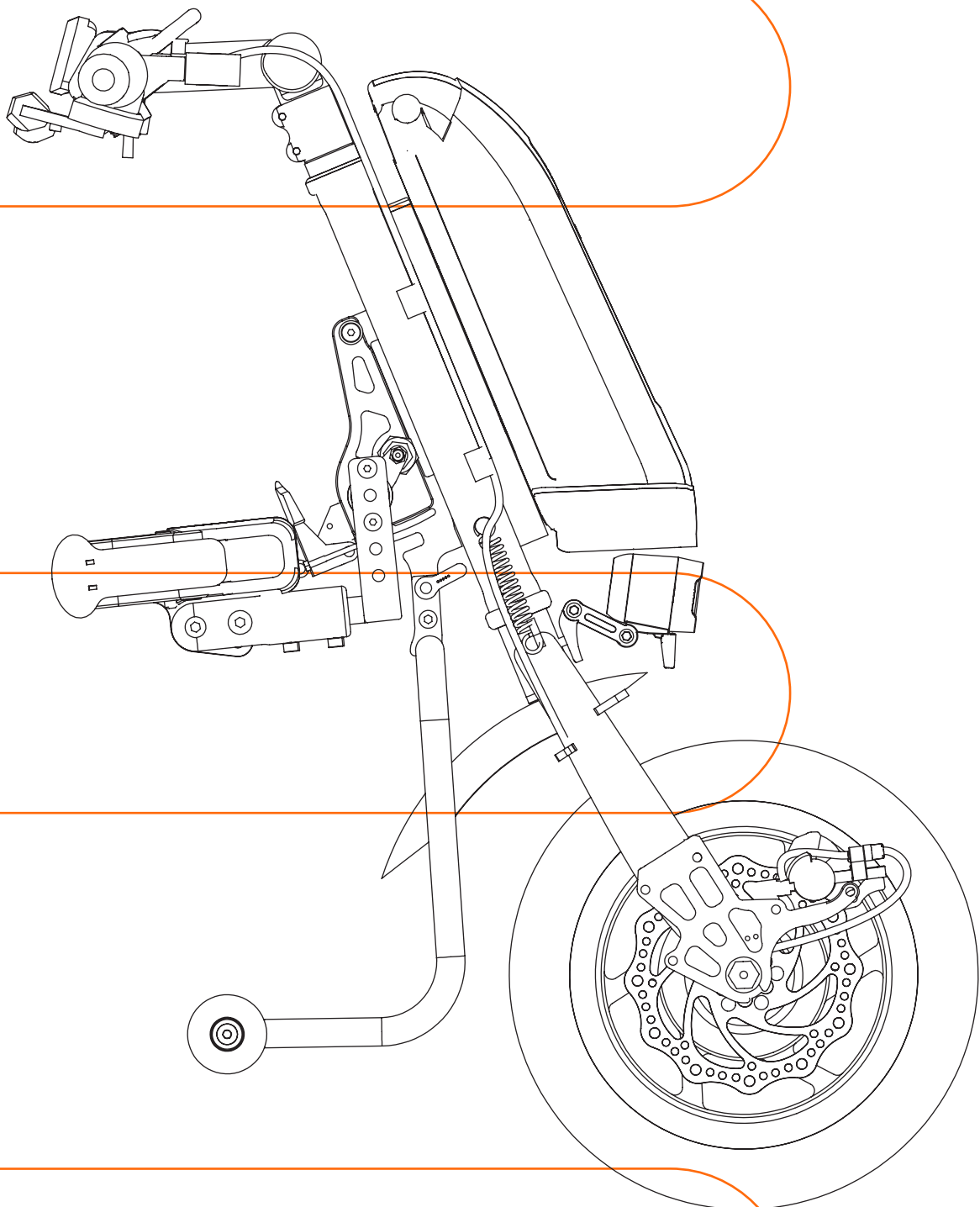

Tools Needed



4mm Allen Key

5mm Allen Key

6mm Allen Key

10mm Spanner

Torque Wrench

Before You Start

- Make sure you have the correct size subframe. This is measured inside tube to inside tube on the front of the frame
- Make sure you have the correct clamps for the chair. There are 3 options:
 1. One Touch Clamps for round tubes: 19-24mm in diameter
 2. One Touch Clamps for round tubes: 25-35mm in diameter
 3. One Touch Clamps for oval tubes: QUICKIE Helium, Nitrum, Xenon² FF

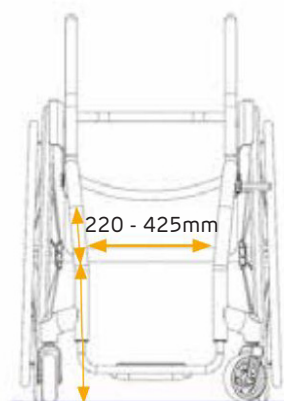

Measured Width
220 - 275mm
275 - 330mm
330 - 425mm

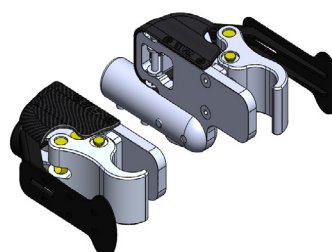

Preparation

- Put the brakes on the wheelchair
- Pull the stand up and screw the handle in (A) to set the stand up
- Attach the 'L' brackets and One Touch Clamps to the StreetJet (B)
- Make sure the StreetJet is disengaged:
 - Unlock the coupling (C)
 - Squeeze the release lever (D)
 - Pull up the subframe (E)

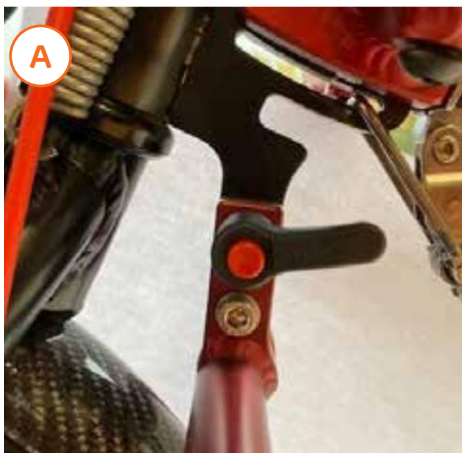

1) Adjust Subframe Height

- Loosen screws (C) and adjust so that the height of the clamps on the frame are at least 350 mm (12") or 365 mm (16") from the ground and the clamps can be mounted on a straight piece of frame (at least 45mm)
- Tighten screws (C) with 16 Nm



2) Set Width

- Using a 5mm and 6mm Allen Key, loosen screws (A, 5mm), (B, 6mm) and screws (C, 5 mm) of the subframe

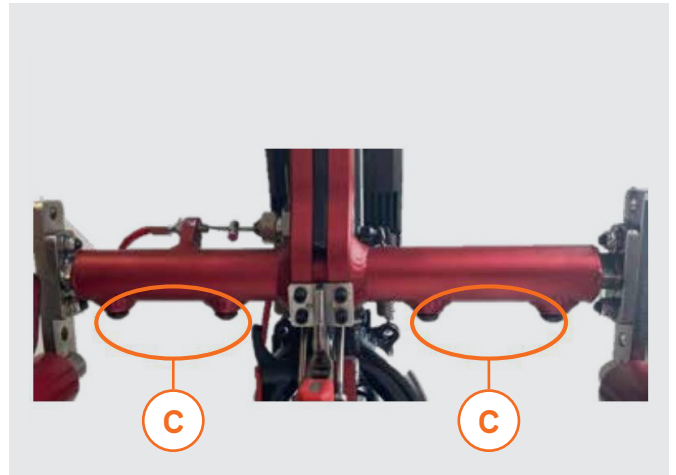

- Place the StreetJet in front of the wheelchair
- Attach the One Touch Clamps to a straight piece of frame on the wheelchair

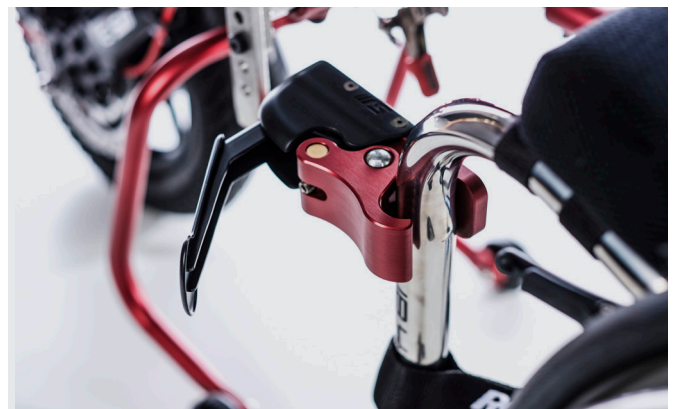

3) Adjust One Touch Clamps

- With a 4mm Allen key, turn the clamps counter clockwise to open
- Place the clamps around the frame and then close the clamps



- Hold the clamps and twist them slightly up, then tighten (A) with a 4mm Allen key

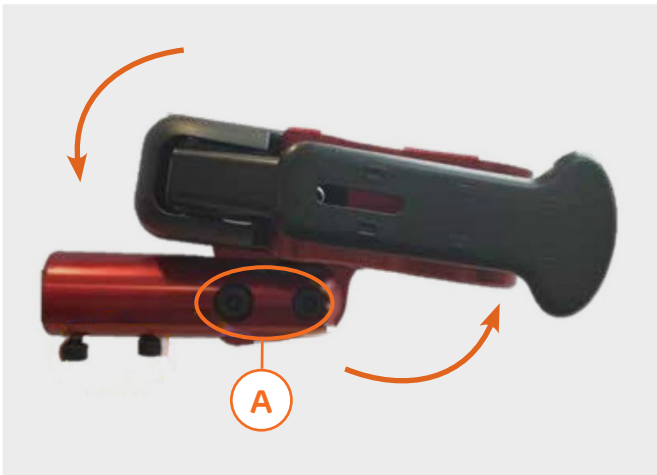

- Spin the drive wheel and ensure that doesn't roll. If it does, the clamps are too tight

4) Adjust Depth

- Make sure the distance between the mounting plate and the One Touch Clamps is equal on both sides and does not exceed 20mm

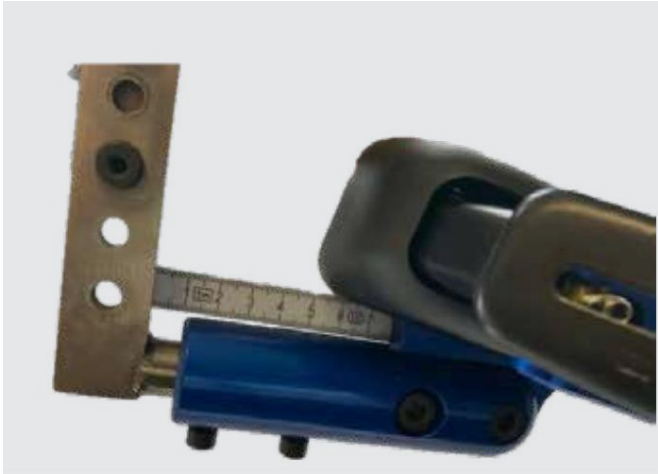

- Tighten screws (A)
- Tighten screws (B) with 16 Nm



Final Checks

- Check the 'L' bracket distance is the same on both sides before tightening them

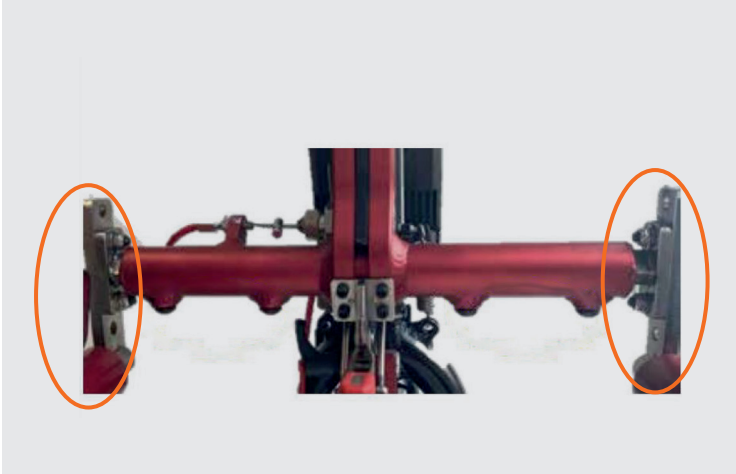

- With a 4mm Allen Key tighten the One Touch Clamps 3/4
- Check the clamps are firmly on the wheelchair
- Adjust as necessary



- ⓘ Check that all bolts are secure and tightened to the correct torque setting

Adjust Steering Position

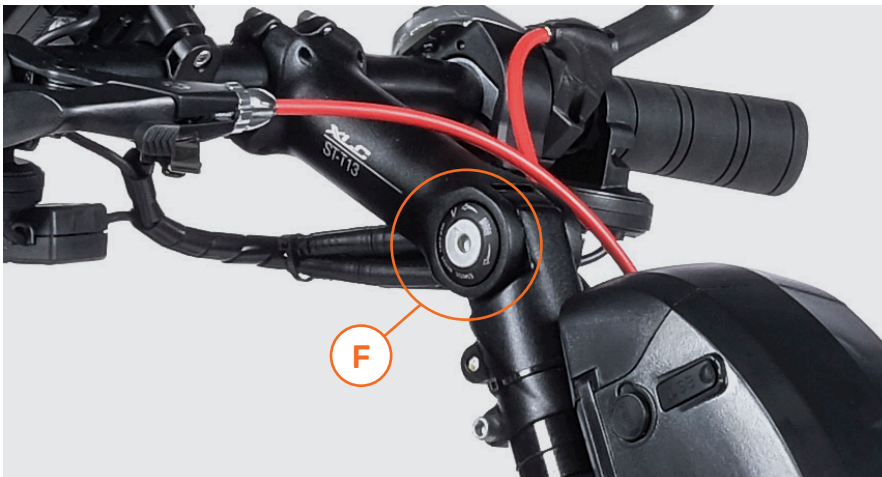

The angle of the steering wheel can be changed from 0° up to 90°

- Loosen screw (F)
- Set the desired angle
- Tighten screw (F) again with 20 Nm



- ⚠ Check that all cables are not bent or stretched. If necessary, use cable ties to guide the cables

Caution

-  Tighten all screws 30 minutes before use and again after 24 hours
-  Make sure there is sufficient space between the wheelchair user's feet and the drive wheel, even with the steering wheel fully engaged
-  Screws with Loctite may only be loosened and tightened 3 times. After this they will need new Loctite 243

Technical Data

Range of action	up to 50 km ¹
Max. user weight	120 kg
Max. speed forward	6 kph; optional 10 or 15 kph
Motor power (max power)	12" 250 W (630 W) / 16" 250 W (750 W)
Max safe slope	6°
Front frame width	220 - 425 mm ²
Battery weight	2.6 kg
Total weight w/o battery	from 12.9 kg ³
Total weight with battery	from 15.5 kg ³
Operating voltage	36 Volt
Battery type	Lithium-ion battery, 36 V 14 Ah, intelligent battery management system
Charger	36V, 2A
Wheel size	12" pneumatic tyre / 16" pneumatic tyre
Brake type	Twin-brake system: mechanical disc brake and separate proportional electric brake. Optional Triple-brake system: dual mechanical brake and separate electric brake

Certified according to all EN12184 applicable standards

(1) According to ISO 7176 - 4, depending on the ground surface, the weight of the user, driving behaviour, temperature and terrain

(2) Measured inside tube to inside tube.
Use only the measured dimension and not the seat width to check compatibility

(3) Depending on product configuration



Thorns Road, Brierley Hill, West Midlands, DY5 2LD
t: +44 (0) 845 605 6688 | e: marketing@sunmed.co.uk

sunrisemedical.co.uk

Sunrise Medical cares about your safety. Please read your owner's manual for safe operating instructions and maintenance guidelines. In line with our policy of continual product improvement, Sunrise Medical reserves the right to make changes at any time, and without notice. For the latest information, please visit www.sunrisemedical.co.uk.