

ACTA-RELIEF™ ORDER FORM



POSITIONING BACK, POSTERIOR LATERAL

Acta-Relief Patent Pending



Shown with Compass® 4 Quick Release 2 Point Hardware.
Cover appearance may vary with hardware selection.

This back support is also available through
CD COMFORT designs

Company Name/ACCT #: _____

P.O. Number: _____

Requested By: _____

Phone: _____ Fax: _____

Email: _____

Ship To: _____

Patient Reference: _____

1 SIZE SELECTION

Required

*Length (L) refers to the actual size dimension of the support from bottom to top edge.

BASE RRP

LENGTH*	22"	£691.00	FRAME WIDTH	
	20"			
	18"			
	16"			
	14"			
	12"			
	10"			
	14"	16"	18"	20"

Sizes available are subject to hardware being used.

AR-BS _____

Please fill in one of the above with dimensions from the size charts to the right.

Example Part: **AR-BS14W16L**

Hardware will be selected in Section 2.

14W10L	16W10L	18W10L	20W10L
--------	--------	--------	--------

Please note these sizes are not available with lateral trunk supports or a head support.

14W12L	16W12L	18W12L	20W12L
--------	--------	--------	--------

Please note these sizes are not available with 4 POINT when using lateral trunk supports.

IF DESIRED SIZE IS NOT LISTED, PLEASE CONTACT CUSTOMER SERVICE FOR ASSISTANCE.
00.353.719163905

Sizes available with 2 POINT Mounting Hardware

LENGTH*	22"	14W22L	16W22L	18W22L	20W22L
	20"	14W20L	16W20L	18W20L	20W20L
	18"	14W18L	16W18L	18W18L	20W18L
	16"	14W16L	16W16L	18W16L	20W16L
	14"	14W14L	16W14L	18W14L	20W14L
	12"	14W12L	16W12L	18W12L	20W12L
	10"	14W10L	16W10L	18W10L	20W10L
	14"	16"	18"	20"	

Sizes available with 4 POINT Mounting Hardware

LENGTH*	22"	14W22L	16W22L	18W22L	20W22L
	20"	14W20L	16W20L	18W20L	20W20L
	18"	14W18L	16W18L	18W18L	20W18L
	16"	14W16L	16W16L	18W16L	20W16L
	14"	14W14L	16W14L	18W14L	20W14L
	12"	14W12L	16W12L	18W12L	20W12L
	10"				
	14"	16"	18"	20"	

Sizes available with POWER Mounting Hardware

LENGTH*	22"	14W22L	16W22L	18W22L	20W22L
	20"	14W20L	16W20L	18W20L	20W20L
	18"	14W18L	16W18L	18W18L	20W18L
	16"	14W16L	16W16L	18W16L	20W16L
	14"	14W14L	16W14L	18W14L	20W14L
	12"	14W12L	16W12L	18W12L	20W12L
	10"				
	14"	16"	18"	20"	

2 COVER & HARDWARE SELECTION

Required

2.1 COVER SELECTION

RRP £0.00

Both fabrics are latex-free. Fabric selection is for the support surface only. Other fabrics used in cover construction remain the same.

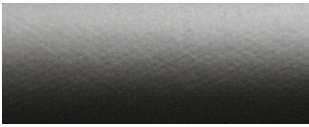

COMFORT-TEK™ is a smooth, easily cleaned surface. The fluid protection aids in infection control.



STRETCH-AIR™ has comfortable stretch, air transmission and heat dissipation. It is not fluid resistant.

COMFORT-TEK™ Cover
(COMFORT-TEK)

STRETCH-AIR™ Cover
(STRETCH-AIR)

2.2 HARDWARE STYLE

COMPASS® 4 QUICK RELEASE

Price included in back support purchase

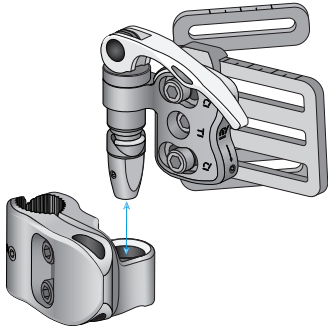

QUICK RELEASE 2 POINT (Q-COMPASS)
QUICK RELEASE 4 POINT (Q-COMPASS4)

4 POINT hardware is required on all 24"W back supports using Compass® 4 hardware.

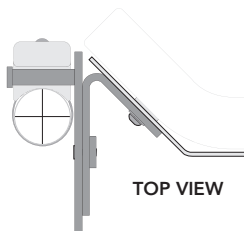

COMPASS® 4 FIXED

Price included in back support purchase

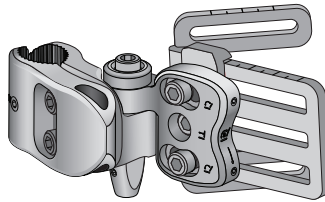

FIXED fully adjustable hardware requires tools for back support removal

FIXED 2 POINT (NQ-COMPASS)
FIXED 4 POINT (NQ-COMPASS4)

COMPASS® POWER MOUNT

RRP add £28.00

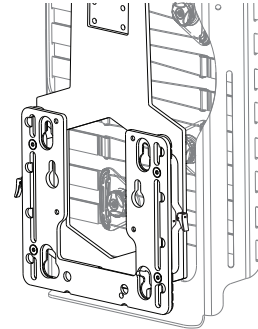

POWER MOUNT hardware has 8" of height adjustment in 1/2" increments without using tools.

QUANTUM w/ TRU BALANCE 3 (PMB-QUANTUM)
PERMOBIL w/ CORPUS 3G (PMB-PERMOBIL)
QUICKIE w/ 3.7 POWER (PMB-QUICKIE)
AVID REHAB w/ POWER T & R (PMB-AVID)
ROVI w/ MOTION CONCEPTS* (PMB-ROVI)

*Using Power Mount Hardware on ROVI requires mounting to the RECESSED PLANAR INTERFACE PLATE available when ordering the Motion Concepts Seating System. Drilling is required for mounting.

3 BACK SUPPORT ADD-ON SELECTIONS

Optional

3.1 COLOR

RRP £24.00

Accent colors are applied via colored piping. Placement of the piping may vary by back support size and mounting hardware. If no colors are selected, our standard silver reflective piping is used at no additional cost.



Color Location

RED (RED)
PURPLE (PURPLE)
PINK (PINK)
BLUE (BLUE)
GREEN (GREEN)
ORANGE (ORANGE)
REMOVE (REMOVE)

3.2 EMBROIDERY

RRP £24.00

A. THREAD COLOR OPTIONS

RED (EMB-RED)	BLUE (EMB-BLUE)
PURPLE (EMB-PURPLE)	GREEN (EMB-GREEN)
PINK (EMB-PINK)	SILVER (EMB-SILVER)

B. FONT OPTIONS

Helvetica (EMB-Helvetica)	Twilight (EMB-Twilight)
Garamond (EMB-Garamond)	Script (EMB-Script)

C. WORD ONE

WORD TWO (optional)

*ADDITIONAL LEAD TIMES MAY APPLY

3.3 PRIVACY FLAP

RRP £33.00

This flap connects with hook & loop attachment between the seat and back for added privacy.

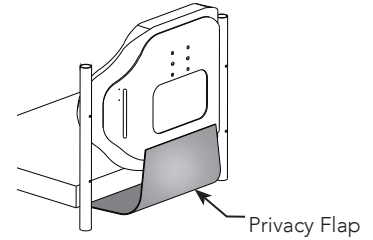

PRIVACY FLAP (PV-FLAP)

4 BODILINK® LATERAL TRUNK SUPPORT & HARDWARE

4.1 BASIC PAD SIZE & SHAPE

RRP £56.00

- You may make one selection per column (Left, Extra Left, Right, and Extra Right) in section 4.1.
- Follow each column down to sections 4.2 and 4.3 (next page) and select a style and cover for each pad selected in section 4.1. Premium pads in section 4.4 on next page.

*Length (L) refers to the actual size dimension of the support from top to bottom edge. Depth (D) refers to the actual size dimension from anterior to posterior edge.

	SHAPE	SIZE	LEFT	*EXTRA LEFT	RIGHT	*EXTRA RIGHT
SUPPORTIVE		3"L x 4"D	BL-LTSP1S-3L4D-LH	BL-LTSP1S-3L4D-LH	BL-LTSP1S-3L4D-RH	BL-LTSP1S-3L4D-RH
		3"L x 5"D	BL-LTSP1S-3L5D-LH	BL-LTSP1S-3L5D-LH	BL-LTSP1S-3L5D-RH	BL-LTSP1S-3L5D-RH
		4"L x 5"D	BL-LTSP1S-4L5D-LH	BL-LTSP1S-4L5D-LH	BL-LTSP1S-4L5D-RH	BL-LTSP1S-4L5D-RH
		4"L x 6"D	BL-LTSP1S-4L6D-LH	BL-LTSP1S-4L6D-LH	BL-LTSP1S-4L6D-RH	BL-LTSP1S-4L6D-RH
		5"L x 7"D	BL-LTSP1S-5L7D-LH	BL-LTSP1S-5L7D-LH	BL-LTSP1S-5L7D-RH	BL-LTSP1S-5L7D-RH
		6"L x 6"D	BL-LTSP1S-6L6D-LH	BL-LTSP1S-6L6D-LH	BL-LTSP1S-6L6D-RH	BL-LTSP1S-6L6D-RH
ACTIVE		3"L x 4"D	BL-LTSP1A-3L4D-LH	BL-LTSP1A-3L4D-LH	BL-LTSP1A-3L4D-RH	BL-LTSP1A-3L4D-RH
		3"L x 5"D	BL-LTSP1A-3L5D-LH	BL-LTSP1A-3L5D-LH	BL-LTSP1A-3L5D-RH	BL-LTSP1A-3L5D-RH
		4"L x 5"D	BL-LTSP1A-4L5D-LH	BL-LTSP1A-4L5D-LH	BL-LTSP1A-4L5D-RH	BL-LTSP1A-4L5D-RH
		4"L x 6"D	BL-LTSP1A-4L6D-LH	BL-LTSP1A-4L6D-LH	BL-LTSP1A-4L6D-RH	BL-LTSP1A-4L6D-RH
		5"L x 7"D	BL-LTSP1A-5L7D-LH	BL-LTSP1A-5L7D-LH	BL-LTSP1A-5L7D-RH	BL-LTSP1A-5L7D-RH
		6"L x 6"D	BL-LTSP1A-6L6D-LH	BL-LTSP1A-6L6D-LH	BL-LTSP1A-6L6D-RH	BL-LTSP1A-6L6D-RH

Contact Customer Support for custom sizes. 00.353.719163905.

4.2 BASIC PAD STYLE

RRP £0.00

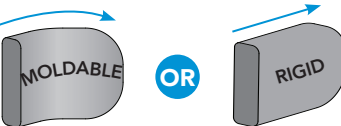

	STYLE OPTIONS	LEFT	*EXTRA LEFT	RIGHT	*EXTRA RIGHT
OR	MOLDABLE	LTS-P1-MOLD	LTS-P1-MOLD	LTS-P1-MOLD	LTS-P1-MOLD
	RIGID	LTS-P1-RIGID	LTS-P1-RIGID	LTS-P1-RIGID	LTS-P1-RIGID

Continue on next page for cover selection (section 4.3) if basic style pads are selected.

**EXTRA" parts may not fit depending on back support, pad, and hardware size and style combinations. Please contact customer support with questions.

ACTA-RELIEF-ORDER REV0418

4.3 BASIC PAD COVER

RRP £0.00

COMFORT-TEK™
FOR FLUID PROTECTION & AN EASILY CLEANED SURFACE.

STRETCH-AIR™
FOR AIR TRANSMISSION & HEAT DISSIPATION.

COVER OPTIONS		LEFT	*EXTRA LEFT	RIGHT	*EXTRA RIGHT
OR	COMFORT-TEK™	LTS-P1-COMFORT	LTS-P1-COMFORT	LTS-P1-COMFORT	LTS-P1-COMFORT
	STRETCH-AIR™	LTS-P1-STRETCH	LTS-P1-STRETCH	LTS-P1-STRETCH	LTS-P1-STRETCH

4.4 PREMIUM PAD SIZE & SHAPE

RRP £79.00

- You may make one selection per column (Left, Extra Left, Right, and Extra Right) in section 4.4.
- Follow each column down to sections 4.5 and 4.6 and select a style and cover for each pad selected in section 4.4.

*Length (L) refers to the dimension of the support from top to bottom edge. Depth (D) refers to the dimension of the support from anterior to posterior edge.

	SHAPE	SIZE	LEFT	*EXTRA LEFT	RIGHT	*EXTRA RIGHT
SUPPORTIVE		3"L x 4"D	BL-LTSP2S-3L4D-LH	BL-LTSP2S-3L4D-LH	BL-LTSP2S-3L4D-RH	BL-LTSP2S-3L4D-RH
		3"L x 5"D	BL-LTSP2S-3L5D-LH	BL-LTSP2S-3L5D-LH	BL-LTSP2S-3L5D-RH	BL-LTSP2S-3L5D-RH
		4"L x 5"D	BL-LTSP2S-4L5D-LH	BL-LTSP2S-4L5D-LH	BL-LTSP2S-4L5D-RH	BL-LTSP2S-4L5D-RH
		4"L x 6.5"D	BL-LTSP2S-4L6D-LH	BL-LTSP2S-4L6D-LH	BL-LTSP2S-4L6D-RH	BL-LTSP2S-4L6D-RH
		5"L x 6.5"D	BL-LTSP2S-5L6D-LH	BL-LTSP2S-5L6D-LH	BL-LTSP2S-5L6D-RH	BL-LTSP2S-5L6D-RH
		6"L x 6.5"D	BL-LTSP2S-6L6D-LH	BL-LTSP2S-6L6D-LH	BL-LTSP2S-6L6D-RH	BL-LTSP2S-6L6D-RH
ACTIVE		3"L x 4"D	BL-LTSP2A-3L4D-LH	BL-LTSP2A-3L4D-LH	BL-LTSP2A-3L4D-RH	BL-LTSP2A-3L4D-RH
		3"L x 5"D	BL-LTSP2A-3L5D-LH	BL-LTSP2A-3L5D-LH	BL-LTSP2A-3L5D-RH	BL-LTSP2A-3L5D-RH
		4"L x 5"D	BL-LTSP2A-4L5D-LH	BL-LTSP2A-4L5D-LH	BL-LTSP2A-4L5D-RH	BL-LTSP2A-4L5D-RH
		4"L x 6.5"D	BL-LTSP2A-4L6D-LH	BL-LTSP2A-4L6D-LH	BL-LTSP2A-4L6D-RH	BL-LTSP2A-4L6D-RH
		5"L x 6.5"D	BL-LTSP2A-5L6D-LH	BL-LTSP2A-5L6D-LH	BL-LTSP2A-5L6D-RH	BL-LTSP2A-5L6D-RH
		6"L x 6.5"D	BL-LTSP2A-6L6D-LH	BL-LTSP2A-6L6D-LH	BL-LTSP2A-6L6D-RH	BL-LTSP2A-6L6D-RH

4.5 PREMIUM PAD STYLE

RRP £0.00

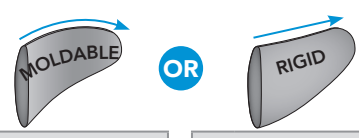

*"EXTRA" parts may not fit depending on back support, pad, and hardware size and style combinations. Please contact customer support with questions.

STYLE OPTIONS		LEFT	*EXTRA LEFT	RIGHT	*EXTRA RIGHT
OR	MOLDABLE	LTS-P2-MOLD	LTS-P2-MOLD	LTS-P2-MOLD	LTS-P2-MOLD
	RIGID	LTS-P2-RIGID	LTS-P2-RIGID	LTS-P2-RIGID	LTS-P2-RIGID

4.6 PREMIUM PAD COVER

COVER OPTIONS	RRP	LEFT	*EXTRA LEFT	RIGHT	*EXTRA RIGHT
NO COVER	£0.00	LTS-P2-NO-CV	LTS-P2-NO-CV	LTS-P2-NO-CV	LTS-P2-NO-CV
COMFORT-TEK™	£0.00	LTS-P2-COMFORT	LTS-P2-COMFORT	LTS-P2-COMFORT	LTS-P2-COMFORT
STRETCH-AIR™	£0.00	LTS-P2-STRETCH	LTS-P2-STRETCH	LTS-P2-STRETCH	LTS-P2-STRETCH
GLIDEWEAR®	£13.00	LTS-P2-GLIDE	LTS-P2-GLIDE	LTS-P2-GLIDE	LTS-P2-GLIDE
COMFORT-TEK™ with FOAM	£13.00	LTS-P2-COMFORT-FM	LTS-P2-COMFORT-FM	LTS-P2-COMFORT-FM	LTS-P2-COMFORT-FM
STRETCH-AIR™ with FOAM	£13.00	LTS-P2-STRETCH-FM	LTS-P2-STRETCH-FM	LTS-P2-STRETCH-FM	LTS-P2-STRETCH-FM
GLIDEWEAR® with FOAM	£13.00	LTS-P2-GLIDE-FM	LTS-P2-GLIDE-FM	LTS-P2-GLIDE-FM	LTS-P2-GLIDE-FM

COMFORT-TEK™
FOR FLUID PROTECTION & AN EASILY CLEANED SURFACE.

STRETCH-AIR™
FOR AIR TRANSMISSION & HEAT DISSIPATION.

GlideWear
FOR SKIN PROTECTION & SHEAR REDUCTION. NOT FLUID RESISTANT.

COVER with FOAM
FOR SOFT FEEL, NON-ZERO CUSHIONING SUPPORT.

4.7 GT MOUNTING HARDWARE

*"EXTRA" parts may not fit depending on back support, pad, and hardware size and style combinations.

Both Fixed and Swing-Away hardware styles are adjustable.

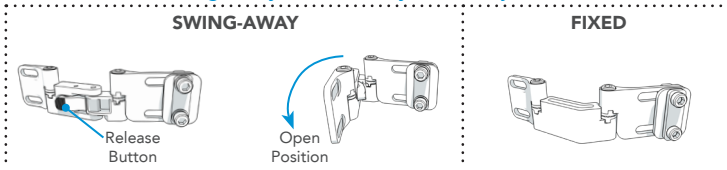

- You may make one selection per column (Left, Extra Left, Right, and Extra Right) in section 4.7.
- GT and GT2 Hardware and Pad styles are interchangeable.
- GT hardware extra links (section 4.8) will only work with GT style hardware.

SLOT MOUNTING		RRP	LEFT	*EXTRA LEFT	RIGHT	*EXTRA RIGHT
OR	SWING-AWAY	£68.00	BL-LTS-GT1SAK-LH	BL-LTS-GT1SAK-LH	BL-LTS-GT1SAK-RH	BL-LTS-GT1SAK-RH
	FIXED	£54.00	BL-LTS-GT1FXK-LH	BL-LTS-GT1FXK-LH	BL-LTS-GT1FXK-RH	BL-LTS-GT1FXK-RH

4.8 GT ADDITIONAL OPTIONS

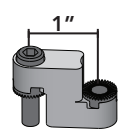

EXTRA HARDWARE LINKS	LEFT	ADD'L LEFT	RIGHT	ADD'L RIGHT
RRP £18.00/link	BL-LTS-GT1LINK	BL-LTS-GT1LINK	BL-LTS-GT1LINK	BL-LTS-GT1LINK



HARDWARE COVER	LEFT	*EXTRA LEFT	RIGHT	EXTRA RIGHT
RRP £17.00/ea	BL-LTS-HCOVER	BL-LTS-HCOVER	BL-LTS-HCOVER	BL-LTS-HCOVER

4.9 GT2 MOUNTING HARDWARE

Both Fixed and Swing-Away hardware styles are adjustable.

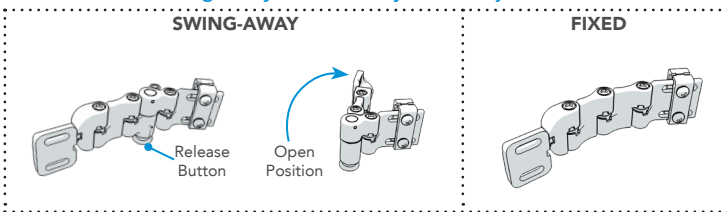

- You may make one selection per column in section 4.9.
- Extra links and long mounting bracket (section 4.10) only for GT2 style hardware.

SLOT MOUNTING		RRP	LEFT	*EXTRA LEFT	RIGHT	*EXTRA RIGHT
OR	SWING-AWAY	£137.00	BL-LTS-GT2SAK-LH	BL-LTS-GT2SAK-LH	BL-LTS-GT2SAK-RH	BL-LTS-GT2SAK-RH
	FIXED	£68.00	BL-LTS-GT2FXK-LH	BL-LTS-GT2FXK-LH	BL-LTS-GT2FXK-RH	BL-LTS-GT2FXK-RH

4.10 GT2 ADDITIONAL OPTIONS

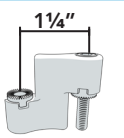

EXTRA HARDWARE LINKS	LEFT	ADD'L LEFT	RIGHT	ADD'L RIGHT
RRP £18.00/link	BL-LTS-GT2LINK	BL-LTS-GT2LINK	BL-LTS-GT2LINK	BL-LTS-GT2LINK

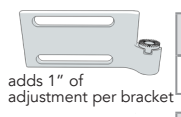

LONG MOUNTING BRACKET	LEFT	*EXTRA LEFT	RIGHT	*EXTRA RIGHT
For Slot Mount RRP £18.00/ea	BL-LTS-GT2LSLOT-LH	BL-LTS-GT2LSLOT-LH	BL-LTS-GT2LSLOT-RH	BL-LTS-GT2LSLOT-RH

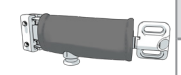

HARDWARE COVER	LEFT	*EXTRA LEFT	RIGHT	*EXTRA RIGHT
RRP £17.00/ea	BL-LTS-HCOVER	BL-LTS-HCOVER	BL-LTS-HCOVER	BL-LTS-HCOVER

5 BODILINK® HEAD SUPPORT HARDWARE & PADS

- You may make one selection per column.
- Choose between premium (5.1) -or- basic (5.3).
- Choose a cover material in 5.2 -or- 5.4.

5.1 PREMIUM PAD SIZE

RRP £98.00

Length (L) refers to the actual size dimension of the support from bottom to top edge.

W		Pad Firmness	
L	6W x 3L	Soft	BL-HSP1-6W3L
		Extra Soft	BL-HSP2-6W3L
L	8W x 4L	Soft	BL-HSP1-8W4L
		Extra Soft	BL-HSP2-8W4L
L	10W x 5L <i>with adjustable wings</i>	Soft	BL-HSP1-10W5L
		Extra Soft	BL-HSP2-10W5L
L	12W x 5L <i>with adjustable wings</i>	Soft	BL-HSP1-12W5L
		Extra Soft	BL-HSP2-12W5L
L	14W x 5L <i>with adjustable wings</i>	Soft	BL-HSP1-14W5L
		Extra Soft	BL-HSP2-14W5L
L	18W x 5L <i>with adjustable wings</i>	Soft	BL-HSP1-18W5L
		Extra Soft	BL-HSP2-18W5L



Premium Head Support Pads angles can be formed by adjusting the plates in the pad.

5.2 PREMIUM PAD COVER MATERIAL

	FOR SKIN PROTECTION & SHEAR REDUCTION. NOT FLUID RESISTANT.
	FOR FLUID PROTECTION & AN EASILY CLEANED SURFACE.
	FOR AIR TRANSMISSION & HEAT DISSIPATION.

	GlideWear® (GLIDEWEAR) (additional cost)
	Comfort-Tek (COMFORT-TEK)
	Stretch-Air (STRETCH-AIR)

5.3 BASIC PAD SIZE

RRP £69.00

Length (L) refers to the actual size dimension of the support from bottom to top edge.

W		
L	6W x 5L	BL-HSP3-6W5L
L	8W x 5L	BL-HSP3-8W5L
L	10W x 6L	BL-HSP3-10W6L
L	12W x 6L	BL-HSP3-12W6L
L	14W x 6L	BL-HSP3-14W6L
L	18W x 6L	BL-HSP3-18W6L



Basic head support pads can be formed to any shape using the moldable steel insert inside the pad.

5.4 BASIC PAD COVER MATERIAL

	FOR FLUID PROTECTION & AN EASILY CLEANED SURFACE.
	FOR AIR TRANSMISSION & HEAT DISSIPATION.

	Comfort-Tek (COMFORT-TEK)
	Stretch-Air (STRETCH-AIR)

5.5 HEAD SUPPORT HARDWARE

- You may make one selection per column in either A -or- B.
- If choosing 5.5 A, choose a stem length option to the right.
- Choose which mounting block option you require in 5.6.

A. PT HARDWARE, REMOVABLE

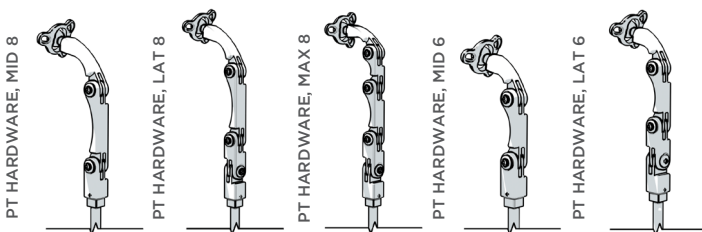

SIZE & SHAPE	RRP
MID 8	£134.00
LAT 8	£159.00
MAX 8*	£134.00
MID 6	£159.00
LAT 6	£187.00

PART NUMBER	
(BL-HS-PT1RMMID8)	
(BL-HS-PT1RMLAT8)	
(BL-HS-PT1RMMAX8)	
(BL-HS-PT1RMMID6)	
(BL-HS-PT1RMLAT6)	

*Provides the greatest amount of articulation and range of motion.

PT HARDWARE RANGE OF MOTION

PT MODEL	TOTAL # OF LINKS	TOTAL LINK LENGTH	MAX. ANTERIOR REACH	MAX. POSTERIOR REACH	MAX. LATERAL REACH
MID 8	2	8"	7.5"	1"	N/A
LAT 8	3	8"	7.5"	1"	8"
MAX 8	4	8"	7.5"	3"	8"
MID 6	2	6"	5.5"	1"	N/A
LAT 6	3	6"	5.5"	1"	6"

PT HARDWARE (CONTINUED)
PT HARDWARE, STEM LENGTH OPTION

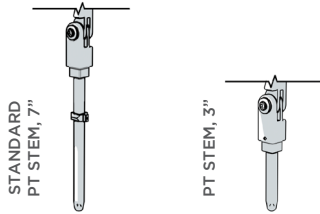

STEM LENGTH	RRP	PART NUMBER	
STANDARD 7" STEM	£0.00	(HS-STEM-7)	
***3" STEM	£0.00	(HS-STEM-3)	

***3" Stem is recommended for use with power mounting where there may be special constraints with power chair functions

B. GT HARDWARE, REMOVABLE

GT HARDWARE RANGE OF MOTION

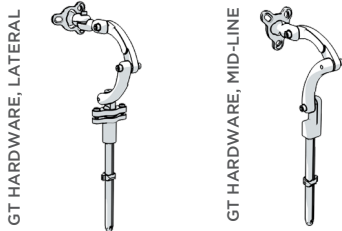

GT MODEL	TOTAL # OF LINKS	TOTAL LINK LENGTH	MAX. ANTERIOR REACH	MAX. POSTERIOR REACH	MAX. LATERAL REACH
LAT	5	10.5"	10"	2"	7.5"
MID	3	8.5"	8"	2"	N/A

SIZE & SHAPE	RRP	PART NUMBER	
LATERAL	£102.00	(BL-HS-GT3RMLAT)	
MID-LINE	£102.00	(BL-HS-GT3RMMID)	

5.6 HEAD SUPPORT MOUNTING OPTION

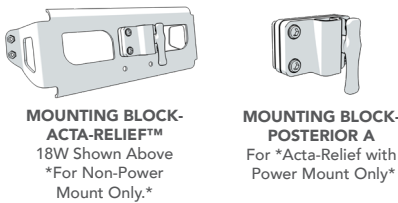

MOUNTING BLOCK OR BRACKET	RRP	PART NUMBER	
*ACTA-RELIEF™ 14W MOUNTING BLOCK	£55.00	(HS-MB-AR14W)	
*ACTA-RELIEF™ 16W MOUNTING BLOCK	£55.00	(HS-MB-AR16W)	
*ACTA-RELIEF™ 18W MOUNTING BLOCK	£55.00	(HS-MB-AR18W)	
*ACTA-RELIEF™ 20W MOUNTING BLOCK	£55.00	(HS-MB-AR20W)	
POSTERIOR A MOUNTING BLOCK	£0.00	(HS-MB-POSTA)	

*For Acta Relief™, includes mounting bracket and POSTA block.
 If you already have an Acta-Relief™ head support bracket, order POSTA Block

5.7 EXTRA HARDWARE

LINK LENGTH	RRP	EXTRA PART	
**EXTRA 2" LINK	£43.00	(BL-HS-PT1LINK2)	

**EXTRA 3" LINK	£43.00	(BL-HS-PT1LINK3)	
-----------------	--------	------------------	--

**EXTRA 4" LINK	£43.00	(BL-HS-PT1LINK4)	
-----------------	--------	------------------	--

TOOL-LESS WING LOCK	RRP	EXTRA PART	EXTRA PART	EXTRA PART	EXTRA PART
**1 LOCK	£16.00	(BL-HS-52WINGA1)	(BL-HS-52WINGA1)	(BL-HS-52WINGA1)	(BL-HS-52WINGA1)

**FOR PT HARDWARE ONLY

MOUNTING BLOCK OR BRACKET	RRP	PART NUMBER	
*ACTA-RELIEF™ 14W MOUNTING BRACKET	£109.00	(BL-HS-AR14W)	
*ACTA-RELIEF™ 16W MOUNTING BRACKET	£109.00	(BL-HS-AR16W)	
*ACTA-RELIEF™ 18W MOUNTING BRACKET	£109.00	(BL-HS-AR18W)	
*ACTA-RELIEF™ 20W MOUNTING BRACKET	£109.00	(BL-HS-AR20W)	

*Bracket only, does not include mounting block.

ADDITIONAL	RRP	EXTRA PART	
1/4" SPACER PLATE	£29.00/each	(BL-HS-SPCRA)	